

# Juodupė production facilities

## Prospect overview

Juodupė town fosters traditions in light industrial manufacturing processes since year 1907, when wool textile processing factory was established. Textile industry at Juodupė had employed over 1000 people back in its days of prosperity and products were shipped all over Europe and over the Atlantic.



Overview of the facilities from the top

Juodupė factory has been very central to the professional and social life of Juodupė community. The town and adjacent region have cost competitive and qualified labor force available and is willing to attract an investor for the welfare of the town and the region.

Facilities plan is displaced in next page. There are 5 production buildings, Water treatment station, Transformer station, Combing shop, Weaving shop, Entry post, Water tower, Pump house. Total area of 17 086,06 square meters

Buildings are in lengthy or wide footprint - good for line or stage-gate production and storage. Materials of construction are reinforced concrete and bricks; construction period within years 1969-1980.

Juodupė facilities feature all utilities necessary for industrial production processes.

Distance to Riga port - 160 km (2:10h), Klaipėda port - 340 km (4:30h).

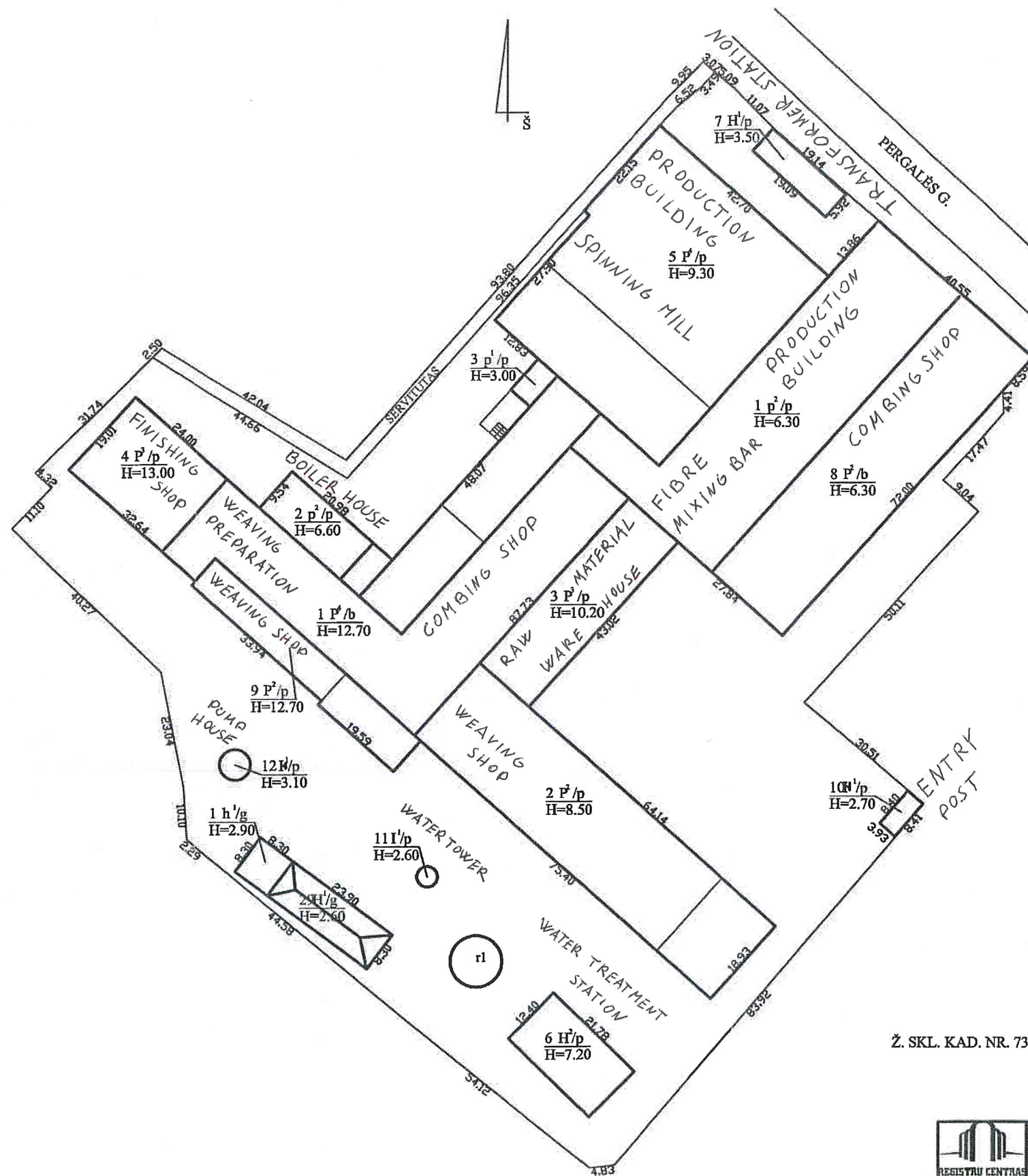

Ž. SKL. KAD. NR. 7363/0009:307

 Valstybės įmonės Registrų centro Panevėžio filialas Licencijos Nr.24G-502, išduota 2002-12-18			
Pareigos	V., pavardė	Paršas	Data
matininkė asistentė	R.Buckienė		2008-06-5
Grupės vedėjas	D.Šimkuvienė		
STATINIŲ IŠDĖSTYMO PLANAS		1:1000	A.V.
Rokiškio r. sav. Juodupės mstl. Pergalės g. 4			
Sudarytas pagal 2008-06-05 kadastrinių matavimų duomenis		Pastato pažymėjimas plane	

Juodupė factory is equipped with a lot of various textile machines:

Name of property
Weaving looms
Mini warping machine
Shaft transportation unit MOD C2
Boiler house equipment
Bobbin winding machines
Spinning machines
Sewing machines
Rejection machine
Winding machine
Fabric ripping machines
Washing-dyeing machines
Felting machine
Brushing - steaming machine
Control - measuring machines
Duplicating - measuring machine
Grinding machine
Hemming machines
Fibre mixing machine
Carding unit

Name of property
Shearing machine Texima
Teasing machine Texima
Fabric stabilization line Texima
Fabric drying machine
Paired fibre dyeing unit THEN
Combing unit
Fibre drying machine
Mixing-emulsifying machine
Scratching-emulsifying machine
Picking unit
Dyeing unit
Carbonization bath
Uninterrupted operation decatizer Superotto Rimar
Combing units
Teasing machine Texima
Centrifuge 210 kg volume
Fibre compression machine
Shearing machine Texima
Fringing machine LAFER

Juodupė has brand new boiler room (since 2017). Technical specifications of boiler room – 3t/h steam boiler room with dry type economizer. While burning fuel oil it produces steam which could be used as a energy source for industrial processes, such as textile production. Picture of the boiler is provided below:



As mentioned before – Juodupė has Water treatment station, Water tower, Pump house – all of this provides not only smooth water supply, but also water treatment possibilities.

Electrical capacity - 630 kW power component.

We are interested in cooperating in all types of performance of activities:

- ✓ Cooperating with doing business at the fabric;
- ✓ Selling the property;
- ✓ Renting it.

If you are interested for cooperation, have any questions, please contact us:

Telephone + 370 67018601

Email: [zs@zaliasisslenis.lt](mailto:zs@zaliasisslenis.lt)